

☒☒☒☒☒☒

☒☒☒☒☒☒

☒☒ ☒☒☒☒

☒☒ ☒☒☒

☒☒ -ò ó ì- í ò ö

5☒

0☒☒☒

☒

SSOM

☒ ☒☒☒☒☒☒

☒ ☒☒☒☒☒☒☒

☒ ☒☒☒☒☒☒☒☒

☒ ☒☒☒☒☒

☒ ☒

EMM

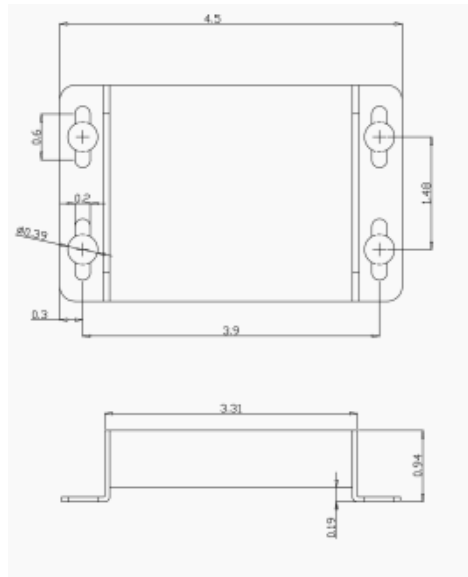

Electrical and Mechanical Specifications

Physical	Aluminum enclosure Size 3.5" x 2.75" x .75"	
Temp	Storage (-55°C to +150°C) Operating (-40°C to +80°C*)	
Humidity	95% (non-condensing)	
Power	Input	Unreg Input 8 to 16VDC* @ 200ma Max
	Output	+5vDC @ 100 ma
Data I/O	Interface	Reader - Wiegand, Strobed (Clock & Data), F/2F LED - 0 to 30v